

Flat roof - fdrhbi01b-00

flat roof, timber frame construction, ventilated, with dry lining, not suspended, other surface

Performance rating

Fire protection performance	REI	60
maximum span = 5 m; maximum load $E_{d,fi} = 3,66 \text{ kN/m}^2$ Classified by IBS		
Thermal performance	U Diffusion	0.17 $\text{W}/(\text{m}^2\text{K})$ suitable
Calculated by HFA		
Acoustic performance	$R_w (C;C_{tr})$ $L_{n,w} (C_i)$	51 (-3;-8) dB
Assessed by TGM		
Mass per unit area	m	44.50 kg/m^2
Calculation based on GF		

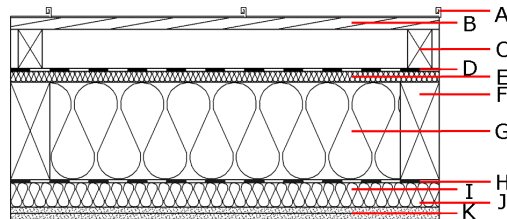
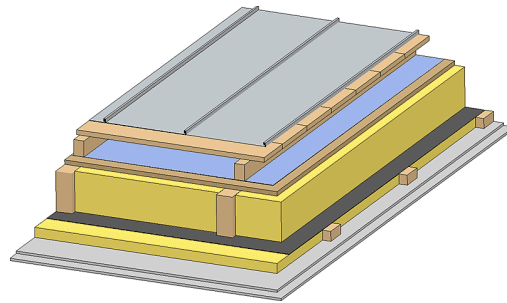

Note: The design of the under-roof construction and of the counter-battens have to be specified according to the roof pitch and the national requirements.

Register of building materials used for this application, cross-section (from outside to inside, dimensions in mm)

Thickness	Building material	Thermal performance				Reaction to fire EN
		λ	μ min – max	ρ	c	
A	sheet metal roofing or plastic roofing membrane			7800		A1
A	Plastic roofing membrane					E
B	24.0 spruce wood closed cladding without spacing of cladding boards	0.120	50	450	1.600	D
C	80.0 spruce wood counter battens (ventilation)	0.120	50	450	1.600	D
D	sarking membrane $s_d \leq 0,3\text{m}$			1000		E
E	22.0 softboard [045; 250] - rigid underlay	0.045	5	250	2.100	E
F	200.0 construction timber (80/*; e=800)	0.120	50	450	1.600	D
G	200.0 mineral wool [040; ≥ 16 ; $< 1000^\circ\text{C}$]	0.040	1	16	1.030	A1
H	vapour barrier $s_d \geq 2\text{m}$			1000		
I	50.0 spruce wood cross battens (50/80;a=400)	0.120	50	450	1.600	D
J	50.0 mineral wool [040; ≥ 16 ; $< 1000^\circ\text{C}$] or without insulation in type O1	0.040	1	16	1.030	A1
K	25.0 gypsum fibre board (2x12,5 mm) or	0.320	21	1000	1.100	A2
K	25.0 gypsum plaster board type DF (2x12,5 mm)	0.250	10	800	1.050	A2

Sustainability rating (per m^2)

Database ecoinvent

$O13_{kon}$ 38.7

Calculated by HFA

Details of sustainability rating

Database ecoinvent

Lifecycle (Phases)	GWP [kg CO ₂ -e.]	AP [kg SO ₂ -e.]	EP [kg PO ₄ -e.]	ODP [kg R11-e.]	POCP [kg Ethen-e.]	
A1 - A3	-22.784	0.173	0.078	3,06E-6	0.011	

Lifecycle (Phases)	PERE [MJ]	PERM [MJ]	PERT [MJ]	PENRE [MJ]	PENRM [MJ]	PENRT [MJ]
A1 - A3	46.351	596.878	643.230	560.332	22.867	583.199