

Pitched roof - sdrhzi06b-07

pitched roof, timber frame construction, ventilated, with dry lining, not suspended, other surface

Performance rating

Fire protection performance	REI	60
maximum span = 5 m; maximum load $E_{d,fi} = 3,66 \text{ kN/m}^2$ Classified by HFA		
Thermal performance	U Diffusion	0.19 $\text{W}/(\text{m}^2\text{K})$ suitable
Calculated by HFA		
Acoustic performance	R_w (C;C _{tr}) $L_{n,w}$ (C _i)	53(-4;-10) dB
with a tiled roof $R_w = 51$ (-4; -10) dB Assessed by TGM		
Mass per unit area	m	60.50 kg/m^2
Calculation based on gypsum plaster board type DF		

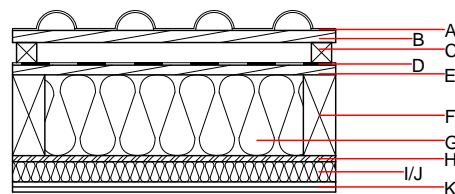
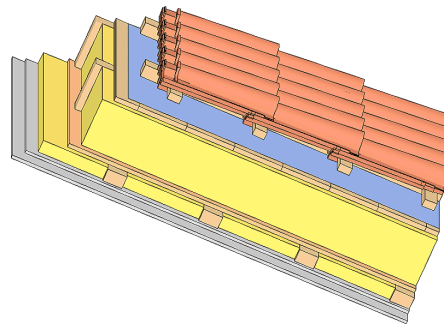

Note: The design of the under-roof construction and of the counter-battens have to be specified according to the roof pitch and the national requirements.

Register of building materials used for this application, cross-section (from outside to inside, dimensions in mm)

Thickness	Building material	Thermal performance				Reaction to fire EN
		λ	μ min – max	ρ	c	
A	concrete roof tile or tiled roof			2100		A1
B 30.0	spruce wood battens (30/50)	0.120	50	450	1.600	D
C 50.0	spruce wood counter battens (minimum height 50 mm)	0.120	50	450	1.600	D
D	sarking membrane $s_d \leq 0,3\text{m}$			1000		E
E 24.0	planking spruce wood closed cladding without spacing of cladding boards	0.120	50	450	1.600	D
F 200.0	construction timber (80/...; e=800)	0.120	50	450	1.600	D
G 200.0	sheep wool [0,041; R=26]	0.041	1	30	1.720	E
H 15.0	OSB (sealed with airtight tape)	0.130	200	600	1.700	D
I 50.0	spruce wood cross battens (50/80;a=400)	0.120	50	450	1.600	D
J 50.0	sheep wool [0,041; R=26]	0.041	1	30	1.720	E
K 25.0	gypsum plaster board type DF (2x12,5 mm) or	0.250	10	800	1.050	A2
K 25.0	gypsum fibre board (2x12,5 mm)	0.320	21	1000	1.100	A2

Sustainability rating (per m^2)

Database ecoinvent

$OI3_{kon}$ 24.1

Calculated by HFA

Details of sustainability rating

Database ecoinvent

Lifecycle (Phases)	GWP [kg CO ₂ -e.]	AP [kg SO ₂ -e.]	EP [kg PO ₄ -e.]	ODP [kg R11-e.]	POCP [kg Ethen-e.]	
A1 - A3	-37.909	0.111	0.048	3,18E-6	0.010	

Lifecycle (Phases)	PERE [MJ]	PERM [MJ]	PERT [MJ]	PENRE [MJ]	PENRM [MJ]	PENRT [MJ]
A1 - A3	55.063	822.344	877.407	448.358	23.368	471.726