

Intermediate floor - gdmnxn02-01

intermediate floor, solid wood construction, without lining, wet, with filling, wooden surface

Performance rating

Fire protection performance	REI	60
maximum span = 5 m; maximum load $E_{d,fi} = 5 \text{ kN/m}^2$ (without floor construction) Classified by HFA		
Thermal performance	U Diffusion	0.44 $\text{W/(m}^2\text{K)}$ suitable
Calculated by HFA		
Acoustic performance	$R_w (C; C_{tr})$ $L_{n,w} (C_i)$	60(-2;-6) dB 57(-1)
Assessed by TU-GRAZ		
Mass per unit area	m	296.70 kg/m^2

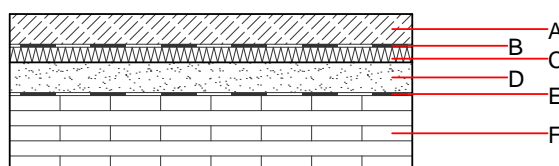
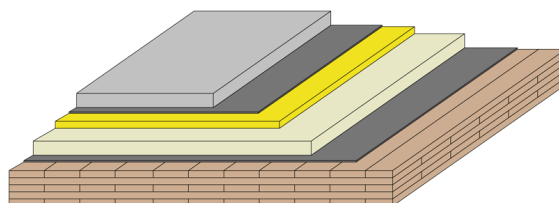

Register of building materials used for this application, cross-section (from outside to inside, dimensions in mm)

	Thickness	Building material	Thermal performance				Reaction to fire EN
			λ	$\mu \text{ min - max}$	ρ	c	
A	60.0	cement screed	1.330	50 - 100	2000	1.080	A1
B		plastic separation layer	0.200	100000	1400	1.400	E
C	30.0	impact sound absorbing subflooring MW-T [$s' = 35 \text{ MN/m}^3$]	0.035	1	120	1.030	A2
D	60.0	non-bonded chippings	0.700	1	1700	1.000	A1
E		trickling protection					E
F	140.0	cross laminated timber, minimum 5-ply, $d \geq 140,0$; first layer minimum 30mm	0.130	50	500	1.600	D

Sustainability rating (per m^2)

Database ecoinvent

013 _{Kon}	48.7
calculated with gypsum plaster fire protection board (GKF/DF); this data includes 3-, 5-, and 7-ply cross laminated timber elements; Calculated by HFA	

Details of sustainability rating

Database ecoinvent

Lifecycle (Phases)	GWP [kg CO ₂ -e.]	AP [kg SO ₂ -e.]	EP [kg PO ₄ -e.]	ODP [kg R11-e.]	POCP [kg Ethen-e.]	
A1 - A3		0.235	0.098	3,38E-6	0.076	

Lifecycle (Phases)	PERE [MJ]	PERM [MJ]	PERT [MJ]	PENRE [MJ]	PENRM [MJ]	PENRT [MJ]
A1 - A3	53.774	957.600	1011.374	728.740	31.697	760.437